



Metal double knob cylinder Euro Profile - for use in indoor areas

Product description

- Communication from hub via RS485 bus to the Online Access Control System (addressable) - access decision in the EAC system
- Compatible with all DIN mortice locks, suitable for locks on glass door wings and walls
- Main electronics (RFID + radio) in the outside knob - secure electronics inside cylinder core
- Freely rotating lock cam
- Outside knob free wheeling - inside knob always engaged (not for VERSION= E/ED, ED/ED)
- Override Credentials: Up to 10 override credentials can be stored for an emergency access in case of failure or no communication with the access control or the hub.
- Smart Credential Handling: In addition to the override credentials, the last valid credentials (up to 1000) can be cached automatically and for a limited time (up to 30 days), so that an opening can still be made without the intervention of the administrator.
- LED for status visualisation









Scope of delivery

- 1 double knob cylinder with battery (Lithium CR2) and installation instructions
- Screws and fixing material (In V3 orders you need to order knob tool separately)

Note

- ASSA ABLOY Sicherheitstechnik GmbH is using open source code in this product. For more information visit <http://www.assaabloy.com/com/global/opensource/>
- * It should be observed that harsh environments may affect product operability (excessive humidity, salt, extreme temperatures)

Technical data - Metal double knob cylinder

	Approvals	CE; fire door up to T90
	Version	Fix or demountable knob versions with or without RFID-Reader
	Knob dimensions	43 x 32 mm (L x Ø)
	Knob surface	Stainless steel
	Cylinder length (LENGTH=A/LENGTH=B)	Basic length 30/30 mm, extendable in 5 mm increments up to 60 mm
	Fixing screw	60 or 85 mm
	Battery	1 x Lithium CR2
	Battery life	10 openings per day for 27 months
	Radio standard	IEEE 802.15.4 (2.4 GHz)
	Encryption (radio communication)	AES 128 bits
	Distance between the RFID-Reader and hub	Typical range 25 m depending on the hub type and building environments
	Class of protection	IP65*
	Operating temperature range	-20° to +55°C
	Status	LED (red/green/orange)
	RFID Technologies (Based on reader type)	High Frequency: iCLASS®/ISO 14443B; MIFARE Classic® / MIFARE® DESFire® EV1&EV2;
		Legic: LEGIC® (Advant, Prime, ISO)/IEC14443 UID, ISO/IEC15693 UID; Optional MIFARE® Support
	RFID reading	UID / Sektor / Block / Application / File
	RFID Reading range	< 4 cm
	Communication interfaces	Micro USB Firmware download (V3 only)

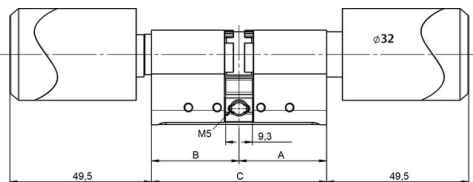
MIFARE™ CLASSIC / PLUS
MIFARE™ CLASSIC / DESFire™